

# Male Connector

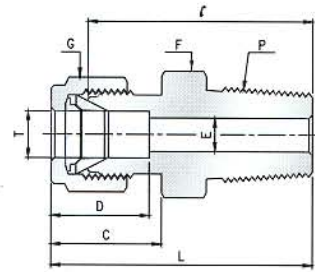
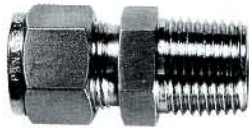

## Imperial Range:

Part No.	Tube O. D. T in	P * (NPT)	E Min	Width across flat		D	C	ℓ	L
				F	G				
				in	in				
PMC-01-01	1/16	1/16	1.27	5/16	5/16	8.63	10.92	20.02	23.83
PMC-01-02	1/16	1/8	1.27	7/16	7/16	8.63	10.92	22.52	26.33
PMC-02-02	1/8	1/8	2.28	7/16	7/16	12.70	15.24	23.88	30.48
PMC-02-04	1/8	1/4	2.28	9/16	7/16	12.70	15.24	28.96	35.56
PMC-02-06	1/8	3/8	2.28	11/16	7/16	12.70	15.24	29.21	35.81
PMC-02-08	1/8	1/2	2.28	7/8	7/16	12.70	15.24	35.56	42.16
PMC-03-02	3/16	1/8	3.04	7/16	1/2	13.71	16.00	24.63	31.24
PMC-03-04	3/16	1/4	3.04	9/16	1/2	13.71	16.00	29.71	36.32
PMC-04-02	1/4	1/8	4.82	1/2	9/16	15.24	17.78	25.40	32.76
PMC-04-04	1/4	1/4	4.82	9/16	9/16	15.24	17.78	30.48	37.84
PMC-04-06	1/4	3/8	4.82	11/16	9/16	15.24	17.78	30.99	38.35
PMC-04-08	1/4	1/2	4.82	7/8	9/16	15.24	17.78	37.34	44.70
PMC-04-12	1/4	3/4	4.82	1-1/16	9/16	15.24	17.78	38.86	46.22
PMC-05-02	5/16	1/8	4.82	9/16	5/8	16.25	18.54	26.67	34.03
PMC-05-04	5/16	1/4	6.35	9/16	5/8	16.25	18.54	31.24	38.60
PMC-05-06	5/16	3/8	6.35	11/16	5/8	16.25	18.54	31.75	39.11
PMC-06-02	3/8	1/8	4.82	5/8	11/16	16.76	19.30	27.94	35.30
PMC-06-04	3/8	1/4	7.11	5/8	11/16	16.76	19.30	32.51	39.87
PMC-06-06	3/8	3/8	7.11	11/16	11/16	16.76	19.30	32.51	39.87
PMC-06-08	3/8	1/2	7.11	7/8	11/16	16.76	19.30	38.86	46.22
PMC-06-12	3/8	3/4	7.11	1-1/16	11/16	16.76	19.30	40.39	47.75
PMC-08-02	1/2	1/8	4.82	13/16	7/8	22.86	21.84	28.70	38.86
PMC-08-04	1/2	1/4	7.11	13/16	7/8	22.86	21.84	33.27	43.43
PMC-08-06	1/2	3/8	9.65	13/16	7/8	22.86	21.84	33.27	43.43
PMC-08-08	1/2	1/2	10.41	7/8	7/8	22.86	21.84	38.86	49.02
PMC-08-12	1/2	3/4	10.41	1-1/16	7/8	22.86	21.84	40.38	50.54
PMC-08-16	1/2	1	10.41	1-3/8	7/8	22.86	21.84	46.99	57.15
PMC-10-06	5/8	3/8	9.65	15/16	1	24.38	21.84	34.03	44.19
PMC-10-08	5/8	1/2	11.93	15/16	1	24.38	21.84	38.86	49.02
PMC-10-12	5/8	3/4	12.70	1-1/16	1	24.38	21.84	40.38	50.54
PMC-12-08	3/4	1/2	11.93	1-1/16	1-1/8	24.38	21.84	40.38	50.54
PMC-12-12	3/4	3/4	15.74	1-1/16	1-1/8	24.38	21.84	40.38	50.54
PMC-12-16	3/4	1	15.74	1-3/8	1-1/8	24.38	21.84	46.99	57.15
PMC-14-12	7/8	3/4	15.74	1-3/16	1-1/4	25.90	21.84	40.38	50.54
PMC-14-16	7/8	1	18.28	1-3/8	1-1/4	25.90	21.84	46.99	57.15
PMC-16-08	1	1/2	11.93	1-3/8	1-1/2	31.24	26.41	45.21	57.40
PMC-16-12	1	3/4	15.74	1-3/8	1-1/2	31.24	26.41	45.21	57.40
PMC-16-16	1	1	22.35	1-3/8	1-1/2	31.24	26.41	50.04	62.23

All dimensions are in millimeters unless otherwise specified. Dimensions are for reference only, subject to change.