

# Reducing Union

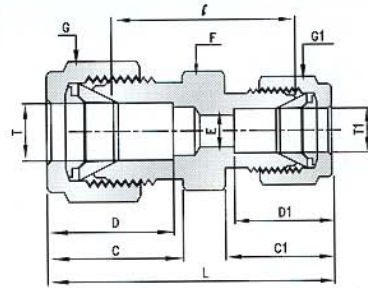
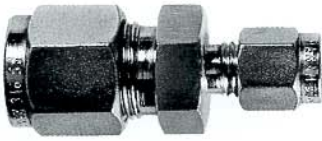

## Imperial Range:

Part No.	Tube O. D.		E Min	Width across flat			D	D <sub>1</sub>	C	C <sub>1</sub>	ℓ	L
	T	T <sub>1</sub>		F	G	G <sub>1</sub>						
	in	in		Min	in	in						
PRU-02-01	1/8	1/16	1.27	7/16	7/16	5/16	12.7	8.63	15.24	10.92	17.71	30.91
PRU-03-02	3/16	1/8	2.28	7/16	1/2	7/16	13.71	12.70	16.00	15.24	23.35	36.57
PRU-04-02	1/4	1/8	2.28	1/2	9/16	7/16	15.24	12.70	17.78	15.24	23.88	38.60
PRU-04-03	1/4	3/16	3.04	1/2	9/16	1/2	15.24	13.71	17.78	16.00	25.40	39.37
PRU-05-02	5/16	1/8	2.28	9/16	5/8	7/16	16.25	12.70	18.54	15.24	25.90	39.87
PRU-05-04	5/16	1/4	4.82	9/16	11/16	9/16	16.25	15.24	18.54	17.78	27.43	42.16
PRU-06-02	3/8	1/8	2.28	5/8	11/16	7/16	16.76	12.70	19.30	15.24	26.92	40.89
PRU-06-04	3/8	1/4	4.82	5/8	11/16	9/16	16.76	15.24	19.30	17.78	28.44	43.18
PRU-06-05	3/8	5/16	6.35	5/8	7/8	5/8	16.76	16.25	19.30	18.54	29.46	44.19
PRU-08-02	1/2	1/8	2.28	13/16	7/8	7/16	22.86	12.70	21.84	15.24	28.44	45.21
PRU-08-04	1/2	1/4	4.82	13/16	7/8	9/16	22.86	15.24	21.84	17.78	29.46	46.99
PRU-08-06	1/2	3/8	7.11	13/16	1	11/16	22.86	16.76	17.78	19.30	30.98	48.51
PRU-10-06	5/8	3/8	7.11	15/16	1	11/16	24.38	16.76	21.84	19.30	31.75	49.27
PRU-10-08	5/8	1/2	10.41	15/16	1-1/8	7/8	24.38	22.86	21.84	21.84	31.75	52.07
PRU-12-04	3/4	1/4	4.82	1-1/16	1-1/8	9/16	24.38	15.24	21.84	17.78	31.75	49.27
PRU-12-06	3/4	3/8	7.11	1-1/16	1-1/8	11/16	24.38	16.76	21.84	19.30	33.27	50.80
PRU-12-08	3/4	1/2	10.41	1-1/16	1-1/8	7/8	24.38	22.86	21.84	21.84	33.27	53.59
PRU-12-10	3/4	5/8	12.70	1-1/16	1-1/8	1	24.38	24.38	21.84	21.84	33.27	53.59
PRU-16-08	1	1/2	10.41	1-3/8	1-1/2	7/8	31.24	22.86	26.41	21.84	40.89	63.24
PRU-16-12	1	3/4	15.74	1-3/8	1-1/2	1-1/8	31.24	24.38	26.41	21.84	40.38	62.73

## Metric Range:

Part No.	Tube O. D.		E Min	Width across flat			D	D <sub>1</sub>	C	C <sub>1</sub>	ℓ	L
	T	T <sub>1</sub>		F	G	G <sub>1</sub>						
	mm	mm		mm	mm	mm						
PRU-M06-03	6	3	2.4	14	14	12	15.3	12.9	17.7	15.3	24.6	38.6
PRU-M06-04	6	4	2.4	14	14	12	15.3	13.7	17.7	16.1	25.4	39.4
PRU-M08-06	8	6	4.8	15	16	14	16.2	15.3	18.6	17.7	27.4	42.3
PRU-M10-06	10	6	4.8	18	19	14	17.2	15.3	19.5	17.7	29.5	44.5
PRU-M10-08	10	8	6.4	18	19	16	17.2	16.2	19.5	18.6	30.0	45.1
PRU-M12-06	12	6	4.8	22	22	14	22.8	15.3	22.0	17.7	29.5	47.0
PRU-M12-08	12	8	6.4	22	22	16	22.8	16.2	22.0	18.6	30.2	47.8
PRU-M12-10	12	10	7.9	22	22	19	22.8	17.2	22.0	19.5	31.0	48.7
PRU-M16-12	16	12	9.5	24	25	22	24.4	22.8	22.0	22.0	31.8	52.0
PRU-M25-18	25	18	15.1	35	38	30	31.3	24.4	26.5	22.0	38.6	61.0
PRU-M25-20	25	20	15.9	35	38	32	31.3	26.0	26.5	22.0	39.9	62.3

All dimensions are in millimeters unless otherwise specified. Dimensions are for reference only, subject to change.