

Female Connector

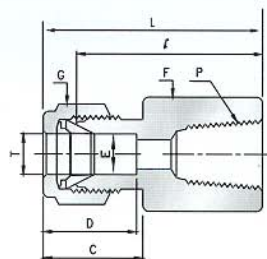
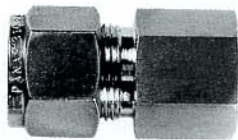

Metric Range: ISO Tapered Thread

Part No.	Tube O. D. T mm	P * R(PT)	E Min	Width across flat		D	C	l	L
				F	G				
				mm	mm				
PFC-M03-02	3	1/8	2.4	14	12	12.9	15.3	22.1	28.7
PFC-M03-04	3	1/4	2.4	19	12	12.9	15.3	26.9	33.5
PFC-M04-02	4	1/8	2.4	14	12	13.7	16.1	23.1	29.7
PFC-M06-02	6	1/8	4.8	14	14	15.3	17.7	23.9	31.3
PFC-M06-04	6	1/4	4.8	19	14	15.3	17.7	28.4	35.8
PFC-M06-06	6	3/8	4.8	22	14	15.3	17.7	29.5	36.9
PFC-M06-08	6	1/2	4.8	27	14	15.3	17.7	35.1	42.5
PFC-M08-02	8	1/8	6.4	15	16	16.2	18.6	24.6	32.1
PFC-M08-04	8	1/4	6.4	19	16	16.2	18.6	29.5	37.0
PFC-M08-06	8	3/8	6.4	22	16	16.2	18.6	30.2	37.7
PFC-M08-08	8	1/2	6.4	27	16	16.2	19.5	35.8	43.3
PFC-M10-02	10	1/8	7.9	18	19	17.2	19.5	25.4	33.0
PFC-M10-04	10	1/4	7.9	19	19	17.2	19.5	30.2	37.8
PFC-M10-06	10	3/8	7.9	22	19	17.2	19.5	31.0	38.6
PFC-M10-08	10	1/2	7.9	27	19	17.2	22.0	36.6	44.2
PFC-M12-02	12	1/8	8.3	22	22	22.8	22.0	28.4	38.5
PFC-M12-04	12	1/4	9.5	22	22	22.8	22.0	30.2	40.3
PFC-M12-06	12	3/8	9.5	22	22	22.8	22.0	31.0	41.1
PFC-M12-08	12	1/2	9.5	27	22	22.8	22.0	36.6	46.7
PFC-M12-12	12	3/4	9.5	35	22	22.8	22.0	38.9	49.0
PFC-M15-08	15	1/2	11.9	27	25	24.4	22.0	36.6	46.7
PFC-M16-08	16	1/2	12.7	27	25	24.4	22.0	36.8	46.9
PFC-M20-08	20	1/2	15.9	30	32	26.0	22.0	37.8	47.9
PFC-M20-12	20	3/4	15.9	35	32	26.0	22.0	39.6	49.7
PFC-M22-12	22	3/4	18.3	35	32	26.0	22.0	39.6	49.7
PFC-M22-16	22	1	18.3	41	32	26.0	22.0	47.8	57.9
PFC-M25-12	25	3/4	21.8	35	38	31.3	26.5	41.1	53.4
PFC-M25-16	25	1	21.8	41	38	31.3	26.5	50.0	62.3

All dimensions are in millimeters unless otherwise specified. Dimensions are for reference only, subject to change.